

राष्ट्रीय प्रौद्योगिकी संस्थान,  
उत्तराखण्ड



**National Institute of Technology,  
Uttarakhand**

**AGENDA FOR THIRD  
MEETING OF  
BUILDING & WORKS COMMITTEE  
Date: 1<sup>st</sup> February, 2014**

**National Institute of Technology,  
Uttarakhand**

**Minutes of the Second Meeting of Building and Works Committee of  
National Institute of Technology, Uttarakhand**

The following members were present:

Prof. H.T. Thorat	- Chairman
Mr. Arun Kumar	- Member
Mr. Alex P. Thomas	- Member
Prof. M.N. Viladkar	- Member
Mr. Salek Chand	- Member
Dr. Vinay Pant	- Member
Prof. V.K. Sharma	- Member

At the outset, the Chairman welcomed all the members and thanked IIT Roorkee and Professor M N Viladkar for providing facilities to conduct the meeting.

The Committee discussed the following agenda:

**BWC 02.01 Confirmation of minutes of the First meeting of Building and Works Committee**

Minutes of the First Meeting of Building and Works Committee are confirmed with addition of comment 'Construction will be taken-up by the agency only after getting the approval of regulatory body if any.', as suggested by Mr. B P Singh.

**BWC 02.02 Action Taken Report**

Noted

**BWC 02.03 Finalization of Agency for establishing the Permanent Campus for the Institute on 'Concept to Commission Basis'.**

The BWC discussed and approved in principle the NBCC Ltd. (as per GFR Amendment to Rule 126(2) as the construction agency for the Phase I. However, individual work shall be assigned with approval of BWC / BoG. Agency charges of NBCC shall be negotiated and shall be approved by BWC / BoG before MOU is signed.

**BWC 02.04 Approval to start the work of Master Plan**

As the Institute does not have technical staff to handle tendering and other related work, tendering for selection of an Architectural firm for Master Plan shall be done by NBCC. Selection of the architectural firm shall be done with the approval of the board. Tendering documents shall be finalized in consultation with Director and charges to be paid to NBCC shall be approved by the Board.

**BWC 02.05 Approval to Constitute the Advisory Committees to discuss designs submitted by the construction agency**

The BWC approved the proposal and authorized the Director, NIT Uttarakhand to take necessary action as per his descretion in this regard.

**BWC 02.06 Approval for the additional cost for foundation of the building to be constructed in ITI**

BWC approved the revised (due silt deposited in recent devastating floods) estimate of Rs. 6,77,96,000/- for the prefabricated construction on pile foundation and execution of Mechanical and Electrical Engineering blocks.

**BWC 02.07 Approval for construction of Pre-fabricated structure for Civil Engineering Department**

BWC approved the estimate of Rs. 3,27,65,000/- for the prefabricated construction on pile foundation and execution of Civil Engineering block.

**BWC 02.08 Approval for construction of Pre-fabricated Hostel in Polytechnic Campus**

BWC approved the estimate of Rs. 1,20,50,000/- for the prefabricated construction and execution of Hostel block.

The meeting ended with Vote of thanks to the Chair.

  
Prof. H.T. Thorat  
(Chairman)

  
Mr. Arun Kumar  
(Member)

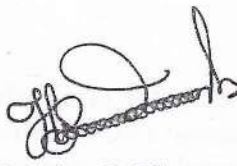
  
Mr. Alex P. Thomas  
(Member)

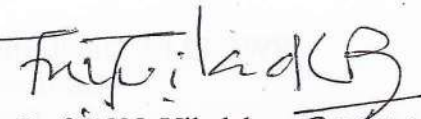
  
Prof. M.N. Viladkar  
(Member)

  
Mr. Salek Chand  
(Member)

  
Dr. Vinay Pant  
(Member)

  
Prof. V.K. Sharma  
(Member)

## National Institute of Technology, Uttarakhand

Minutes of the Meeting convened on 6<sup>th</sup> January 2014 at IIT Roorkee to negotiate Service Charges of NBCC

A meeting is convened on 6<sup>th</sup> January 2014 at IIT Roorkee to negotiate Service Charges of NBCC. NIT Uttarakhand was represented by following officials.

Professor H T Thorat, Director, NITUK  
 Professor V K Sharma, Dean (P&D), NITUK  
 Professor M N Viladkar, Professor of Civil Engineering, IITR  
 Professor U K Sharma, Professor of Civil Engineering, IITR  
 Professor R Anbalagan, Professor of Earth Sciences, IITR

NBCC was represented by following Members  
 Shri. Nilesh Shah, Executive Director, NBCC  
 Shri. Rajesh Arora, General Manager, NBCC

After deliberating the location of NIT Uttarakhand, Service Charges paid by adjoining Government Institutions and volume of work it was mutually agreed that NIT Uttarakhand shall pay 10% (including all services like architectural service, structural design, geotechnical investigation, topographical survey, field testing, quality control etc.) as Service Charges to PMC over the cost of execution of the construction work.



(H T Thorat)

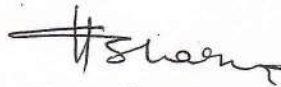

(V K Sharma)



(M N Viladkar)

06/11/14

(U K Sharma)



(R Anbalagan)

(Nilesh Shah)

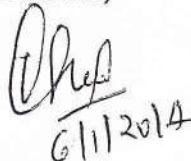

6/11/2014



(Rajesh Arora)

06.01.14.

## National Institute of Technology, Uttarakhand

MINUTES OF THE 4<sup>th</sup> MEETING OF THE BOARD OF GOVERNORS HELD ON 15<sup>th</sup> NOVEMBER 2013.

The following members were present:

- |                           |   |          |
|---------------------------|---|----------|
| 1. Shri Bhaskar Bhat      | - | Chairman |
| 2. Shri Yogendra Tripathi | - | Member   |
| 3. Prof. S. C. Lakkad     | - | Member   |
| 4. Prof. Geetha Nambissan | - | Member   |
| 5. Prof. H. T. Thorat     | - | Member   |
| 6. Prof. V. K. Sharma     | - | Member   |
| 7. Dr. A. S. Dhundi       | - | Member   |

Prof. Pradipta Banerji was out of the country and hence could not attend the meeting.

At the outset, the Chairman welcomed all the members.

The Committee discussed the following agenda:

**BoG 04.01: Confirmation of the Minutes of the third meeting of Board of Governors.**  
Minutes of the Third Meeting of Board of Governors are confirmed.

**BoG 04.02: Action Taken Report**  
Action Taken Report is noted

**BoG 04.03: To note the Minutes of Second Meeting of Building and Works Committee**  
Minutes of Second Meeting of Building and Works Committee are noted & approved.

**BoG 04.04: Finalization of Agency for establishing the Permanent Campus for the Institute on Concept to Commission basis**

The BOG discussed and approved the NBCC Ltd. (as per GFR Amendment to Rule 126(2) as the construction agency for the Phase I. However, individual work shall be assigned with approval of BoG. Agency charges of NBCC shall be negotiated by Director recommended by BWC and shall be approved by FC / BoG before MOU is signed. The Director shall constitute a committee to negotiate with at least one BWC member as part of the committee.

**BoG 04.05: Approval to start the work of Master Plan**

The BOG discussed in detail the need to save the time to select an Architectural Firm, identified by NBCC, and authorised the Director to approve and appoint an Architectural Firm for preparing Master Plan in consultation of BWC. The Director should ensure that NBCC has followed due process of identifying the Architectural firm.

**BoG 04.06: Approval for authorized signatories required for New Pension Scheme (NPS) mechanism**

The BOG discussed and approved authorized signatories required for New Pension Scheme (NPS) mechanism

**BoG 04.07 (A): Ratification of expenses approved by Chairman, Board of Governors.**  
The BOG ratified the expenses approved by Chairman, Board of Governors.

The meeting ended with Vote of thanks to the chair.

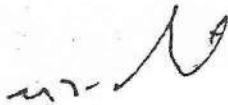

**H T Thorat**  
Director

**Submitted for Approval**

Approved / Not Approved

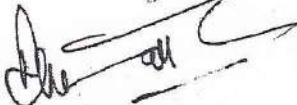

**The Chairman**  
Board of Governors  
NIT, Uttarakhand



A Mini Ratna Schedule 'A' PSE

## NATIONAL BUILDINGS CONSTRUCTION CORPORATION LIMITED

**Zonal Office: NBCC Ltd.**  
**House No.1, Niti Nagar,**  
 Opp. Main Gate, IIT Campus  
**Roorkee-247667**

No. NBCC/ UK/Roorkee/ CONS/2014/09

Dated: 06.01.2014

### **NOTE**

**Sub : Brief in respect of appointment of agency for rendering consultancy services for execution of new NIT-Uttarakhand at village Sumari, Srinagar (Uttarakhand).**

NBCC has appointed M/s. DDF Consultant as an Associate Consultant for rendering Consultancy services for the proposed Construction of the Permanent Campus for the NIT – Uttarakhand at village Sumari, Srinagar Uttarakhand). The appointment of the consultant has been done by following the NBCC procedures which basically involves following steps:

- i. Inviting e-tenders through e-portal and tender wizard from the agencies pre-qualified by NBCC under the appropriate categories.
- ii. The said empanelment of the consultants is done by calling applications from the Architect/consultancy firms. The applications are invited through the e-tendering process. The qualifying criterion is laid down as per the CVC norms.
- iii. The tenders from the empanelled Consultant are invited in two bid system. The first bid comprise the Technical bid, EMD and Tender fee etc. The second Bid comprise the Price Bid. Both the Bids i.e. the Technical Bid and the Price Bid are submitted simultaneously on the Tender Portal in soft copies and also in Hard Copy in the NBCC office by all the Bidders.
- iv. The bidders who fulfill the qualifying criteria are advised to submit the Concept Design Presentation of the proposed work. The Price Bid of only those bidders are opened who pass the Design Concept Presentation.
- v. The Presentation of the Concept Design is made by the bidders who qualify the Technical evaluation stage – I i.e. who have submitted the requisite fee and have qualifying experience as prescribed in the Tender. The Concept Design Presentation of the bidders who have qualified stage – I technical evaluation, is evaluated by a committee. Marking is done by the members based on various components of the Design and the bidders who score at least 75 average marks are intimated a date for opening of their online Price Bid.
- vi. On the Scheduled date, the online Price Bids are opened by the Tender Scrutiny Committee in presence of the representatives of the intending bidders.
- vii. The work is awarded to the lowest bidder.

*Handwritten signature and date:*  
 06.01.14

Accordingly NBCC invited tenders for appointment of Associate Consultants for the Construction of new campus for NIT-Uttarakhand for rendering services of drawings & design of Architecture, structure and services for the subject project through e-tender process from the consultants empanelled with NBCC in the categories of SP-1 (Group-IV and above) and SP-2 (Group-IV and above) as below:

S. No.	Applicable category	Available empanelled agencies
1.	Category C-1 Group V & VI Non specialized projects, Residential Building works (Rs. 100.00 Cr. to Rs. 300.00 Cr.)	i. M/s Arch-En-Design, New Delhi. ii. M/s DDF Consultants, New Delhi. iii. M/s Pentacle Consultant (I) Pvt. Ltd., Mumbai
2.	Category C-2 Group V & VI Non specialized projects, Non Residential Building works (Rs. 100.00 Cr. to Rs. 300.00 Cr.)	i. M/s Rajiva Kumar & Associates, Lucknow
3.	Category SP-1 Group IV & V Specialized projects, Residential Building works. (Rs. 100.00 Cr. to Rs. 300.00 Cr.)	i. M/s. Behal Joshi & Associates, New Delhi. ii. M/s SGAG Consultants Pvt. Ltd. Noida. iii. M/s Enarch Consultants Pvt. Ltd. Noida. iv. M/s Rajinder Kumar Associates, New Delhi. v. M/s Khan Global Engg. Consultants, Bangalore.
4	Category SP-2 Group IV & V Specialized projects, Non Residential Building works. (Rs. 100.00 Cr. to Rs. 300.00 Cr.)	i. M/s Behal Joshi & Associates, New Delhi. ii. M/s Ghosh, Bose & Associates, Kolkata. iii. M/s SGAG Consultants Pvt. Ltd. Noida. iv. M/s Achal Kataria Architects, New Delhi. v. M/s Arch-En-Design, New Delhi. vi. M/s Archivista Engg. Projects (P) Ltd., Chennai. vii. M/s C.P. Kukreja Associates, New Delhi. viii. M/s Design Associates Inc. Noida. ix. M/s En-Arch Consultants Pvt. Ltd. Noida x. M/s Gherzi Eastern Ltd. Pune. xi. M/s Gian P. Mathur & Associates (P) Ltd., New Delhi. xii. M/s Khan Global Engg. Consultants Bangalore. xiii. M/s Mukesh & Associates, Salem (TN) xiv. M/s Pentacle Consultants (I) Pvt. Ltd., Mumbai. xv. M/s Raja Aederi Consultants Pvt. Ltd., New Delhi. xvi. M/s Rajinder Kumar Associates, New Delhi.



The notice inviting tenders for appointment of Associate Consultant for rendering consultancy services of proposed work of construction of new campus for NIT Uttarakhand was uploaded on the e-tender portal and NBCC website. Copies of the NIT were sent by post as well to the eligible empanelled consultants as listed here in above.

In response to the above NIT, following five agencies submitted their tenders (online and hard copies) till the scheduled last date and submission:

1. M/s DDF Consultants, New Delhi.
2. M/s Design Associates Inc., New Delhi.
3. M/s Enarch Consultants (P) Ltd., Noida.
4. M/s Raja Aederi Consultants Pvt. Ltd., New Delhi.
5. M/s Rajinder Kumar & Associates, New Delhi.

All the five participating agencies have submitted the required documents and EMD etc. and hence were qualified for Design Concept Presentation. All the four agencies were asked to submit the hard & soft copies of their Design Concept Presentation. Out of the five qualified participating agencies M/s Raja Aederi Consultants Pvt. Ltd., New Delhi did not submit the Design Concept Presentation and hence the Design Concept Presentation of following agencies was evaluated by the committee:

1. M/s DDF Consultants, New Delhi.
2. M/s Design Associates Inc., New Delhi.
3. M/s Enarch Consultants (P) Ltd., Noida.
4. M/s Rajinder Kumar & Associates, New Delhi.

The evaluation of the Design concept presentation of all the four eligible agencies was done by the committee as per the standard procedure. The agencies who scored at least 70 marks out of 100 marks only were to be considered to qualify for the evaluation of their financial bids. The criteria of marking of Design concept presentation has been as follow:

<b>Master Planning</b>	<b>Total 30</b>
1 Cost effective & grouping of functions	10
2 Site orientation	10
a. Massing	5
b. Circulation	5
c. Landscape blending with explain profile	
<b>Design concept planning</b>	<b>Total 40</b>
1. Accessible and Environmental friendly considerations	10
2. Energy efficient planning	15
3. Disaster resistant methods	5
4. Economical design	5

**Presentation****Total 30**

- |  |    |
|--|----|
| 1. Overall presentation  | 5  |
| 2. Overall understanding of planning   | 15 |
| 3. Presentation of Design concept and response to queries of committee member. | 10 |

---

**Grand Total 100**

---

The financial bids are uploaded on e-portal and hard copies of financial bids are submitted by the participating agencies along with their technical bids itself both these bids together form a complete tender and hence the evaluation process of the Design concepts presentation has no effect on their financial bids.

On evaluation of the Design concept presentation three agencies, out of four agencies, could pass the Design concept presentation by scoring more than 70 marks out of Total 100 marks and then qualified for the financial bids evaluation.

1. M/S DDF Consultants' Pvt. Ltd. New Delhi.
2. M/S Design Associates Inc. New Delhi.
3. M/S Enarch Consultants' Pvt. Ltd. Noida.

All the qualifying agencies were intimated for opening of their online financials bids by the committee .The consultancy fee quoted by the qualifying agencies has been as below:

- |  |       |         |
|--|-------|---------|
| 1. M/S DDF Consultants' Pvt. Ltd. New Delhi. | 0.65% | (L1)    |
| 2. M/S Design Associates Inc. New Delhi.     | 0.95% | (L3)    |
| 3. M/S Enarch Consultants' Pvt. Ltd. Noida.  | 0.87% | (L3) L2 |

Thus M/S DDF Consultants has quoted the least consultancy fee @ 0.65% and had already been qualified the M/S Design Concept presentation and accordingly M/S DDF Consultants has been appointed as the Associate consultant by NBCC for rendering consultancy services for the construction of new campus for NIT-Uttarakhand at village Sumari ,Srinagar (Uttarakhand ).

The scope of work assigned by NBCC to the Associate consultants, M/S DDF consultants, includes among others, the master planning of the project as well. Thus the fee payable by NBCC to the Associate Consultants is for Master planning also. Since there has been no separate quote by the participating agencies towards Master planning since the financial bids have been invited a single quote basis.

M/S DDF consultant is a competent agency having adequate experience, expertise and resources to execute the consultancy services of the project under consideration.

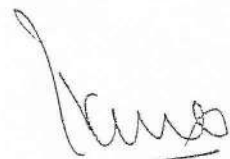
  
06.01.14

It is therefore recommended that the NIT - Uttarakhand may get the Master Planning of the project through M/s. DDF Consultant in view that:

- The agency appointed by NBCC for the consultancy services of the project has adequate experience, expertise and resources to fulfill its obligations.
- The agency has been appointed by NBCC through e-tendering observing the due procedures of the corporation.
- The fee quoted by the agency is quite reasonable and the Scope of the work includes the Master Planning of the Project as well thus the consultancy fee payable to the agency is inclusive of the fee towards Master planning also.
- The quote of consultancy fee is a single quote and fee payable exclusively for the Master Planning alone can't be decided.
- The NIT-Uttarakhand will be required to make no payment separately to the Associate consultant for the Master Planning of the project as the fee payable to the Consultant is inclusive of Master Planning of the Project.

It is therefore proposed that NIT-Uttarakhand may avail the services of M/S DDF consultants for the Master planning of the project for which NIT Uttarakhand will have to make no separate payments to the proposed consultant and the consultancy fee payable by NBCC to the proposed consultant will be inclusive of the Master planning services to be rendered by the proposed consultant to the NIT-Uttarakhand directly.

The Director  
NIT - Uttarakhand.

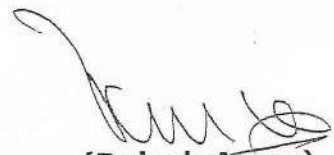
  
(Rajesh Arora)  
GM (UK), Roorkee 14



एन बी सी सी  
A Mini Ratna Schedule 'A' PSE

नेशनल बिल्डिंग्स कन्स्ट्रक्शन कार्पोरेशन लिमिटेड  
(भारत सरकार का उद्यम)  
**NATIONAL BUILDINGS CONSTRUCTION CORPORATION LIMITED**  
(A Government of India Enterprise)

ANNEXURE 03-08



An IS/ISO 9001:2008  
Company  
(For Consultancy &  
Project Management Division)

**Office of GM (Uttarakhand)**  
House No.1, Niti Nagar, Opp. Main Gate  
IIT Campus, Roorkee-247667

No. NBCC/ Roorkee/IIT/NIT (UK)/2014/15

Dated: 09.01.2014

**The Director,**  
NIT Uttarakhand,  
ITI Campus,  
**Srinagar (UK)**

13/01/14  
letter  
Courier  
10704  
Swah

**SUB:** Construction of Compound Wall for Permanent Campus of NIT Uttarakhand at Sumari, Srinagar – Cost Estimate

**REF:** 1. Your Letter No. NITUK/Estate/2013/1983 dated 20.11.2013  
2. This office Letter No. NBCC/Roorkee/IIT/NIT (UK)/2014/613 dated 03.01.2014

Dear Sir,

The estimate and design of the proposed Boundary Wall submitted by this office vide Letter No. NBCC/Roorkee/IIT/NIT (UK)/2014/613 dated 03.01.2014 was discussed during the meeting held at IIT – Roorkee dated 06.01.2014 and it was desired that following three types of arrangements shall be incorporated for the Campus Boundary Wall:

1. Compound Wall in stone masonry with plinth beam & coping, RCC intermediate columns with concertina coil.
2. Chain link fencing in steel frame work
3. M.S. grill compound wall with 10 mm sq. bars at steep slopes to allow flow of water.

We are accordingly submitting the revised estimate and the revised design for the said work at a total cost of Rs. 1327.48 Lacs, including contingencies and NBCC agency charges, for needful approval please.

It is requested that approval for call of tenders for the subject work may please be accorded pending the financial sanction of the work so as to save on time. The work to the contractor will be awarded by NBCC only after receiving financial sanction from your end. This arrangement is proposed with a view to generate some turnover within the current financial year.

Thanking you

AR (Atk)  
8/1  
16.01.14

Yours Faithfully,  
  
(Rajesh Arora)  
GM (Uttarakhand)

Encl.: As above

Copy for information to:

1. The ED, RBG – North, NBCC Ltd., Near Ramp No. 14, Jawahar Lal Nehru Stadium Complex, Lodhi Road, New Delhi

GM (Uttarakhand)  
CORPORATE OFFICE

एनबीसीसी भवन, लोधी रोड, नई दिल्ली-110003  
NBCC Bhawan, Lodhi Road, New Delhi-110003  
दूरभाष / Tel.: 91-11-24367314-17  
फैक्स / Fax: 91-11-24366995

Phone : 01332-275560  
Fax : 01332-274246  
E-mail : nbcc\_iitr@yahoo.in  
nbcc.roorkee@gmail.com

E-mail: info.nbcc@nic.in / Website: www.nbccindia.gov.in

- 14 - -

# NATIONAL BUILDINGS CONSTRUCTION CORPORATION LTD.

(A Mini Ratna Schedule 'A' PSE)

ZONAL OFFICE: GM (UK)

H. No. 1, NITI NAGAR, NH - 58  
ROORKEE - 247667

## CONSTRUCTION OF BOUNDARY WALL FOR PERMANENT CAMPUS OF NIT - UTTARAKHAND AT VILL. SUMARI, SRINAGAR (UTTARAKHAND)

### SUMMARY OF COST

1	EARTHWORK			40,19,585.05
2	CONCRETE WORK			40,93,510.25
3	RCC WORK			6,98,71,775.50
4	BRICK WORK			14,91,028.00
4	STONE WORK			1,31,31,075.15
5	STEEL WORK			60,07,425.00
6	FINISHING			56,82,981.40
7	FENCING WORK			52,02,666.80
	<b>TOTAL</b>			<b>10,95,00,047.15</b>
		ADD FOR COST INDEX @7%	7.0%	76,65,003.30
	<b>TOTAL</b>			<b>11,71,65,050.45</b>
		ADD FOR CONTINGENCIES @ 3%	3.0%	35,14,951.51
	<b>TOTAL</b>			<b>12,06,80,001.96</b>
		ADD NBCC AGENCY CHARGES @ 10%	10.0%	1,20,68,000.20
	<b>GRAND TOTAL</b>			<b>13,27,48,002.15</b>
	<b>SAY</b>		<b>Rs. IN LACS</b>	<b>1,327.48</b>

  
 General Manager (UK)  
 N.B.C.C. Ltd.

**COST ESTIMATE FOR CONSTRUCTION OF BOUNDARY WALL FOR NEW PERMANENT CAMPUS OF NIT  
UTTARAKHAND**

**BOUNDARY WALL**

S. No.	Ref. DSR - 2013 Item No.	Item of Work	Unit	Qty	Scheduled Items (DSR Items)	
					Rate (DSR 2013)	Amount
<b>EARTHWORK</b>						
1	2.8	Earth work in excavation by mechanical means (Hydraulic excavator) / manual means in foundation trenches or drains (not exceeding 1.5 m in width or 10 sqm on plan) including dressing of sides and ramming of bottoms, lift upto 1.5 m, including getting out the excavated soil and disposal of surplus excavated soil as directed, within a lead of 50 m.	cum	11,102.00	148.25	16,45,871.50
1.1	2.8.1	All kinds of soil.				
2.0	2.9	Excavation work by mechanical means (Hydraulic excavator)/ manual means in foundation trenches or drains (not exceeding 1.5m in width or 10 sqm on plan), including dressing of sides and ramming of bottoms, lift upto 1.5 m, including getting out the excavated soil and disposal of surplus excavated soils as directed, within a lead of 50 m.	Cum	2,960.00	244.90	7,24,904.00
2.1	2.9.1	Ordinary rock	cum	740.00	427.75	3,16,535.00
2.2	2.9.2	Hard rock (requiring blasting)				
3.0	2.25	Filling available excavated earth (excluding rock) in trenches, plinth, sides of foundations etc. in layers not exceeding 20cm in depth, consolidating each deposited layer by ramming and watering, lead up to 50 m and lift upto 1.5 m.	Cum	10,822.00	101.50	10,98,433.00
4.0	2.26	Extra for every additional lift of 1.5 m or part thereof in excavation /banking excavated or stacked materials.				
4.1	2.26.1	All kinds of soil.	Cum	3,148.00	41.75	1,31,429.00
4.2	2.26.2	Ordinary or hard rock	cum	787.00	74.90	58,946.30
5.0	2.31	Clearing jungle including uprooting of rank vegetation, grass, brush wood, trees and saplings of girth upto 30 cm measured at a height of 1m above ground level and removal of rubbish upto a distance of 50 m outside the periphery of the area cleared.	100 Sqm	75.00	579.55	43,466.25
<b>TOTAL OF EARTH WORK</b>						
<b>CONCRETE WORK</b>						
6.0	4.1	Providing and laying in position cement concrete of specified grade excluding the cost of centring and shuttering - All work upto plinth level :				
6.1	4.1.8	1:4:8 (1 cement : 4 coarse sand : 8 graded stone aggregate 40 mm nominal size)	cum	761.00	3,920.65	29,83,614.65
6.2	4.1.10	1:5:10 (1 cement : 5 coarse sand : 10 graded stone aggregate 40 mm nominal size)	cum	235.00	3,672.80	8,63,108.00

  
 09.10.2013  
 N.E.C.C. Ltd.  
 Uttarakhand Works, Roorkee

S. No.	Ref. DSR - 2013 Item No.	Item of Work	Unit	Qty	Scheduled Items (DSR Items)	
					Rate (DSR 2013)	Amount
7.0	4.3	Centering and shuttering including strutting, propping etc and removal of form for:				
7.1	4.3.1	Foundations, footings, bases of columns etc for mass concrete	Sqm	48.00	186.40	8,947.20
8.0	4.10	Providing and laying damp-proof course 40 mm thick with cement concrete 1:2:4 (1 cement : 2 coarse sand : 4 graded stone aggregate 12.5 mm nominal size).	Sqm	1,050.00	220.60	2,31,630.00
9.0	4.12	Extra for providing & mixing water proofing material in cement concrete work in doses by weight of cement as recommended by the manufacturer	50 Kg cement used in the mix	140.00	44.36	6,210.40
		<b>TOTAL OF CONCRETE WORK</b>				<b>40,93,510.25</b>
		<b>REINFORCED CEMENT CONCRETE WORK</b>				
10.0	5.9	Centering and shuttering including strutting, propping etc and removal of form for:				
10.1	5.9.1	Foundations, footings, bases of columns etc for mass concrete	Sqm	3,956.00	186.40	7,37,398.40
10.2	5.9.5	Lintels, beams plinth beams, girders, bressumers and cantilevers	Sqm	10,756.00	309.80	33,32,208.80
10.3	5.9.6	Columns, Pillars, Piers, Abutments, Posts and Struts.	Sqm	8,678.00	423.00	36,70,794.00
11.0	5.22	Reinforcement for R.C.C. work including straightening, cutting, bending, placing in position and binding all complete up-to plinth level.	Kg	3,38,418.00	66.50	2,25,04,797.00
11.1	5.22.6	Thermo-Mechanical Treated bars				
12.0	5.22A	Reinforcement for R.C.C. work including straightening, cutting, bending, placing in position and binding all complete above plinth level.	Kg	2,25,612.00	66.50	1,50,03,198.00
12.1	5.22A.6	Thermo-Mechanical Treated bars				
13.0	5.27	Providing and filling in position bitumen mix filler of Proportion 80 kg of hot bitumen, 1 kg. of cement and 0.25 cubicmetre of coarse sand for expansion joints.	per cm width per cm depth per 100 m	85.00	186.10	15,818.50
14.0	5.33	Providing and laying in position machine batched, machine mixed and machinevibrated design mix M25 grade cement concrete for reinforced cement concrete work including pumping of concrete to site of laying but excluding the cost of centring, shuttering, finishing and reinforcement, including Admixtures in improve workability without impairing strength and durability as per direction ofrecommended proportions as per IS 9103 to accelerate, retard setting of concrete cement per cum of concrete. All work upto Plinth level.Engineer-in-charge. Cement content considered in this item is @330 Kg/Cum. Excess/less cement used as per design ix is payable/recoverable separately)	Cum	2,984.08	5,704.45	1,70,22,078.80
14.1	5.33.1	All Work Upto Plinth	Cum	1,194.00	6,353.00	75,85,482.00
14.2	5.33.2	All works above Plinth Level upto floor V Level				
		<b>TOTAL OF RCC WORK</b>				<b>6,98,71,775.50</b>

  
 09/01/2011  
 General Manager (Engg)  
 M.S. Civil.  
 Uttarakhand Road, Roorkee

S. No.	Ref. DSR - 2013 Item No.	Item of Work	Unit	Qty	Scheduled Items (DSR Items)	
					Rate (DSR 2013)	Amount
		<b>BRICK WORK</b>				
15.0	6.1	Brick work with common burnt clay F.P.S. (non modular) bricks of class designation 7.5 in superstructure above plinth level up to floor V level in all shapes and sizes in :				
15.1	6.1.2	Cement mortar 1:6 (1 cement : 6 coarse sand)	cum	280.00	5,325.10	14,91,028.00
		<b>TOTAL OF BRICK WORK</b>				<b>14,91,028.00</b>
		<b>STONE WORK</b>				
16.0	7.8	Coursed rubble masonry with hard stone (first or second sort) in superstructure above plinth level and upto floor five level.				
16.1	7.8.1	Masonry work (first sort) , in cement mortar 1:6 (1 cement : 6 coarse sand)	cum	2,853.00	4,602.55	1,31,31,075.15
		<b>TOTAL OF STONE WORK</b>				<b>1,31,31,075.15</b>
		<b>STEEL WORK</b>				
17.0	10.25	Steel work welded in built up sections/ framed work including cutting, hoisting, fixing in position and applying a priming coat of approved steel primer using structural steel etc. as required.				
17.1	10.25.2	In gratings, frames, guard bar, ladder, railings, brackets, gates and similar works	kg	69,450.00	86.50	60,07,425.00
		<b>TOTAL OF STEEL WORK</b>				<b>60,07,425.00</b>
		<b>FINISHING</b>				
18.0	13.4	12 mm Cement Plaster of mix				
18.1	13.4.1	1:4 (1 cement: 4 Coarse sand)	Sqm	1,480.00	153.85	2,27,698.00
19.0	13.5	15 mm Cement Plaster on rough side of single or half Brick wall of mix				
19.1	13.5.1	1:4 (1 cement: 4 Coarse sand)	Sqm	1,260.00	178.60	2,25,036.00
20.0	13.21	Extra for providing & mixing water proofing material in cement plaster work in proportion recommended by the manufacturer	50 Kg cement used in the mix	1,500.00	46.70	70,050.00
21	13.33	Pointing on stone work with cement mortar 1:3 (1 cement: 3 fine sand) :				
21.1	13.33.2	Raised and cut pointing	sqm	19,018.00	249.35	47,42,138.30
22	13.47	Finishing walls with Premium AcrylicSmooth paint with silicone additives of required shade				
22.1	13.47.1	New work (Two or more coats applied @1.43 ltr/ 10 sqm over and including priming coat of exterior primer applied @2.20 Kg/ 10 Sqm)	sqm	2,500.00	90.00	2,25,000.00
23	13.61	Painting with synthetic enamel paint of approved brand and manufacture of required colour to give an even shade:				
23.1	13.61.1	Two or more coats on new work over an under coat of suitable shade with ordinary paint of approved brand and manufacture.	sqm	3,062.00	63.05	1,93,059.10
		<b>TOTAL OF FINISHING WORK</b>				<b>56,82,981.40</b>

*[Signature]*  
09-01-2014



S. No.	Ref. DSR - 2013 Item No.	Item of Work	Unit	Qty	Scheduled Items (DSR Items)	
					Rate (DSR 2013)	Amount
		<b>FENCING WORK</b>				
24	16.19	Supplying at site Angle iron post & strut of required size including bottom to be split and bent at right angle in opposite direction for 10 cm length and drilling holes upto 10 mm dia. etc. complete.	Kg.	53,032.42	69.75	36,99,011.30
25	16.20	Welded steel wire fabric fencing with posts of specified material and of standard design placed and embedded in cement concrete blocks 45x45x60cm of mix 1:5:10 (1 cement:5 fine sand : 10 graded stone aggregate 40mm nominal size), every 15th post, last but one end post and corner post shall be strutted on both sides and end post on one side only and struts embedded in cement concrete blocks 70x45x50cm of the same mix, provided with welded steel wire fabric fixed between the posts fitted and fixed with G.I. staples on wooden plugs or tied to 6 mm bar nibs with G.I. binding wire (cost of posts, welded steel wire fabric, painting, earth work in excavation and concrete to be paid for separately) :	sqm	5,040.00	25.80	1,30,032.00
26	16.53	Providing and fixing concertina coil fencing with punched tape concertina coil 600 mm dia 10 metre openable length ( total length 90 m) having 50 nos rounds per 6 metre length, upto 3 m height of wall with existing angle iron 'Y' shaped placed 2.4 m or 3.00 m apart and with 9 horizontal R.B.T. reinforced barbed wire, stud tied with G.I. staples and G.I. clips to retain horizontal including necessary bolts or G.I. barbed wire tied to angle iron all complete as per direction of Engineer-in-charge with reinforced barbed tape(R.B.T.) / Spring core (2.5mm thick) wire of high tensile strength of 165 kg/ sq.mm with tape (0.52 mm thick) and weight 43.478gm/ metre (cost of M.S. angle, C.C. blocks shall be paid separately)	metre	4,835.00	284.10	13,73,623.50
<b>TOTAL OF FENCING WORK</b>						<b>52,02,666.80</b>
<b>GRAND TOTAL</b>						<b>10,95,00,047.15</b>

*[Signature]*  
09.01.2014

**Raiesh Arora**

UNIVERSITY OF ENGINEERING & TECHNOLOGY

S.N.	Code	Description Of Items	Nos			Measurement			QTY	Unit		
						L	B	H				
1	2.8	Earth work in excavation by mechanical means (Hydraulic excavator) / manual means in foundation trenches or drains (not exceeding 1.5 m in width or 10 sqm on plan) including dressing of sides and ramming of bottoms, lift upto 1.5 m, including getting out the excavated soil and disposal of surplus excavated soil as directed, within a lead of 50 m.										
			2.8.1	All kinds of soil.								
				In Footings	1	1243		2.10	2.10	2.10	11511.423	Cum
				Single Footing	1	171		3.00	2.10	2.10	2262.33	Cum
				Combined Footing	1	1		2876.70	0.65	0.55	1028.42	Cum
		Plinth Beams	1	480		0.75	0.75	202.50	Cum			
		Pit For Link Chain Fencing	1					14802.17	Cum			
								14802.00	Cum			
								11102.00	Cum			
								2960.00	Cum			
								740.00	Cum			
2	2.26	In ordinary soil In Ordinary Rock In Hard Rock (requiring blasting) Filling available excavated earth (excluding rock) in trenches, plinth, sides of foundations etc. in layers not exceeding 20cm in depth, consolidating each deposited layer by ramming and watering, lead up to 50 m and lift upto 1.5 m.										
3	2.26 2.26.1	Extra for every additional lift of 1.5 m or part thereof in excavation /banking excavated or stacked materials. All kinds of soil.										
		In Footings	1	1243		2.10	2.10	0.60	3288.978	Cum		
		Single Footing	1	171		3.00	2.10	0.60	646.38	Cum		
		Combined Footing	1						3935.358	Cum		
									3935.00	Cum		
		CONCRETE WORK										

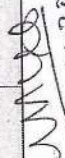
  
 07/01/2014  
 General Manager (Engg)  
 N.E.C.C. Ltd.  
 Uttarakhand Works, Roorkee



2	5.29	Reinforcement for R.C.C. work including straightening, cutting, bending, placing in position and binding all complete.	135.00						4178.00	564030.00 564030.00	Kg Kg
3	5.33	Providing and laying in position machine batched, machine mixed and machinevibrated design mix M25 grade cement concrete for reinforced cement concrete work including pumping of concrete to site of laying but excluding the cost of centring, shuttering, finishing and reinforcement, including Admixtures in improve workability without impairing strength and durability as per direction ofrecommended proportions as per IS 9103 to accelerate, retard setting of concrete cement per cum of concrete. All work upto Plinth level.Engineer-in-charge. M-25 grade reinforced cement concrete by using 380kg. of cement per cum of concrete. All work upto Plinth level.									
	5.33.1	All Work Upto Plinth									
		Footings	1	1243	1	1.50	1.50	0.45	1258.54		Cum
		Single Footing	1	171	1	2.40	1.50	0.45	277.02		Cum
		Combined Footing									
		Coloums In foundation	1	1243	1	0.30	0.45	1.55	260.10		Cum
		Under Foundation	1	171	2	0.30	0.45	1.55	71.56		Cum
		Plinth Beams	1	1	1	5515.95	0.45	0.45	1116.98		Cum
									2984.20		Cum
									2984.00		Cum
	5.33.2	All works above Plinth Level upto floor V Level									
		Coloums Above Plinth	1	1243	1	0.30	0.45	2.10	352.39		Cum
		Top Beams	1	171	2	0.30	0.45	2.10	96.96		Cum
			1	1	1	5515.95	0.45	0.30	744.65		Cum
									1194.00		Cum
									1194.00		Cum
	7.8.1	Stone Work Coursed rubble masonry with hard stone (first or second sort) in superstructure above plinth level and upto floor five level. Masonry work (first sort) , in cement mortar 1:6 (1 cement : 6 coarse sand) Stone Masoary	1 1	1 1	1 1	1998.45 3617.50	0.30 0.30	1.50 1.80	899.30 1953.45 2852.75		Cum
									2853.00		Cum
		STEEL WORK									

*[Handwritten Signature]*  
 01.11.2019

1	10.32	Steel work welded in built up sections/ framed work including cutting, hoisting, fixing in position and applying a priming coat of approved steel primer using structural steel etc. as required.	1	1	1	2315.00	1.20	27700 5995 1500
	10.32.2	In gratings, frames, guard bar, ladder Steel Railing Weight @25 Kg/Sqm	25.00					
	13.33	<b>Finishing Work</b> Pointing on stone work with cement mortar 1:3 (1 cement: 3 fine sand) :	1	1	1	1998.45	1.50	5995 2100
	13.33.2	Raised and cut pointing Stone Masoary	1	1	1	3617.50	1.80	1300 1335 1000
	13.94	Painting with synthetic enamel paint of approved brand and manufacture of required colour to give an even shade:	1	1	1	1998.45	1.20	29914 56336 204650 300000
	13.94.1	Two or more coats on new work over an under coat of suitable shade with ordinary paint of approved brand and manufacture. Steel Railing MS Angle for Concentina Wire	1	1	1	1998.45	0.10	
			1	1382	2	2.40		
	16.19	<b>Road Work</b> Supplying at site Angle iron post & strut of required size including bottom to be split and bent at right angle in opposite direction for 10 cm length and drilling holes upto 10 mm dia. etc. complete. MS Angle for Concentina Wire 50X50X6.00 mm MS Angle for Chain Link 65X65X6.0 mm	1	1382	2	2.40	4.5	29914 56336 204650 300000
			1	480	1	3.60	5.8	29914 56336 204650 300000
26	16.20	Welded steel wire fabric fencing with posts of specified material and of standard design placed and embedded in cement concrete blocks 45x45x60cm of mix 1:5:10 (1 cement:5 fine sand : 10 graded stone aggregate 40mm nominal size), every 15th post, last but one end post and corner post shall be struted on both sides and end post on one side only and struts embedded in cement concrete blocks 70x45x50cm of the same mix, provided with welded steel wire fabric fixed between the posts fitted and fixed with G.I. staples on wooden plugs or tied to 6 mm bar nibs with G.I. binding wire (cost of posts, welded	1	1382	2	2.40	Kg/metre	29914 56336 204650 300000
			1	480	1	3.60	Kg/metre	29914 56336 204650 300000

16.53	Chain Link Fencing	Providing and fixing concertina coil fencing with punched tape concertina coil 600 mm dia 10 metre openable length ( total length 90 m) having 50 nos rounds per 6 metre length, upto 3 m height of wall with existing angle iron 'Y' shaped placed 2.4 m or 3.00 m apart and with 9 horizontal R.B.T. reinforced barbed wire, stud tied with G.I. staples and G.I. clips to retain horizontal including necessary bolts or G.I. barbed wire tied to angle iron all complete as per direction of Engineer-in-charge with reinforced barbed tape(R.B.T.) / Spring core (2.5mm thick) wire of high tensile strength of 165 kg/ sq.mm with tape (0.52 mm thick) and weight 43.478gm/ metre (cost of M.S. angle, C.C. blocks shall be paid separately)	1	1.00	1.00	1,680.00	3.00	5,040.00	Sqm
								4835.00	Metre

*Musa*  
09-01-2014

**Rajesh ARORA**  
General Manager (Engg.)  
N.B.C.C. Ltd.  
Umarakhand Works, Roorkhee

PROPOSED SITE OF N.I.T. AT SUMARI, DISTT. PAURI GARHWAL

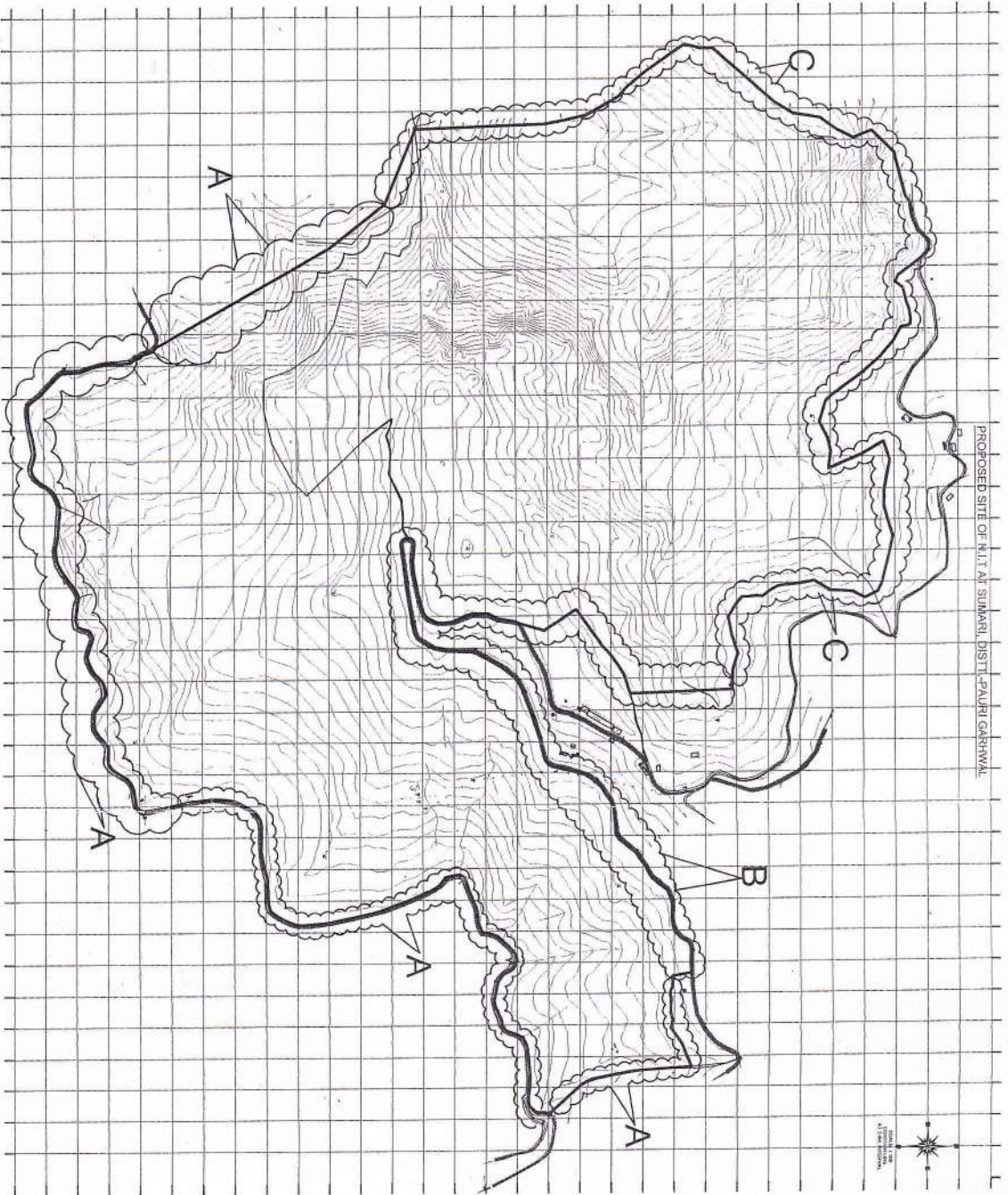

WALL TYPE - A LENGTH = 2520 M  
 WALL TYPE - B LENGTH = 1680 M  
 WALL TYPE - C LENGTH = 2315 M

MKD.	DATE	DESCRIPTION	WORKS BY
		1. PROCT 2. REF. (ENG) C. Ltd.	
		10/10/2014	

REVISIONS-

NIT UTTARAKHAND

ISSUED FOR CONSTRUCTION  
 ISSUED: VEERANDRA  
 DATE: 03.01.2014

SCALE: ARCHITECTURE

DATE: JAN. 2014 SITE DEVELOPMENT

DEALT: SEEMA LOCATION PLAN

CHECKED: VEERANDRA OF BOUNDARY WALL

APPROVED: SAURABH DRG NO. REV.

DDFO/VA/R/D/E/T-10000 R1

MR. LISTING AGENCY NATIONAL BUILDING CONSTRUCTION CO. LTD.

CORPORATION LTD., NEW DELHI

ASSOCIATE CONSULTANT:

DDF Consultants Pvt. Ltd.



DETAILED PLAN OF BOUNDARY WALL TYPE B

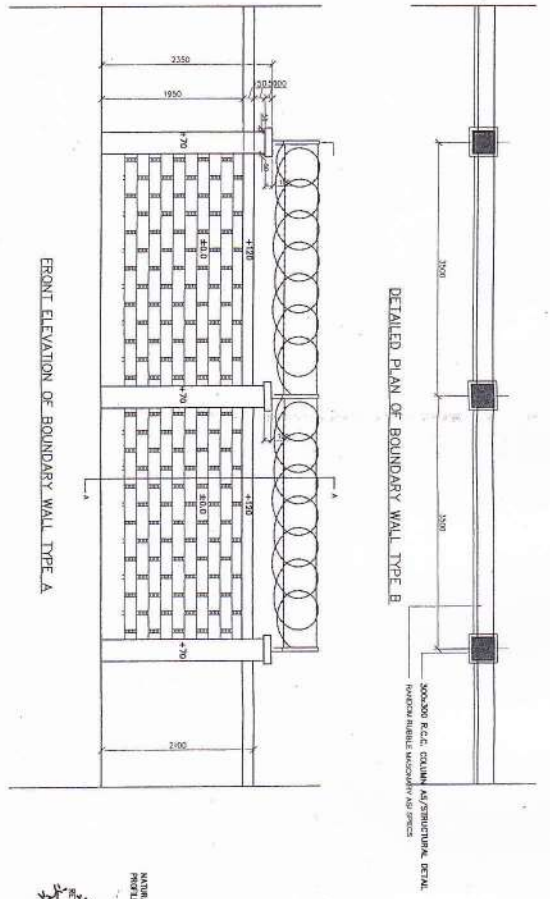

FRONT ELEVATION OF BOUNDARY WALL TYPE A

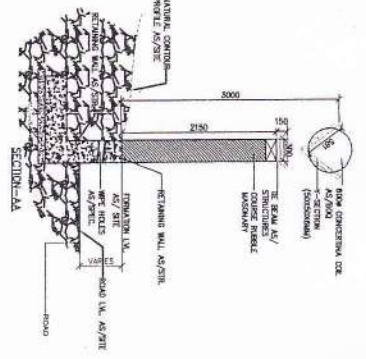
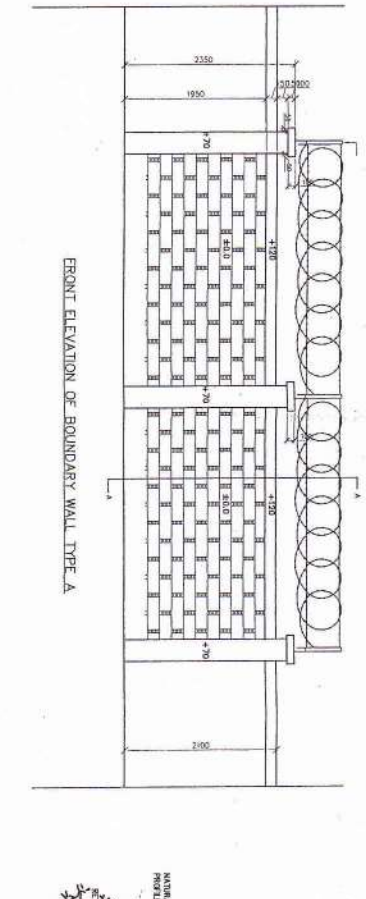

FRONT ELEVATION OF BOUNDARY WALL TYPE C

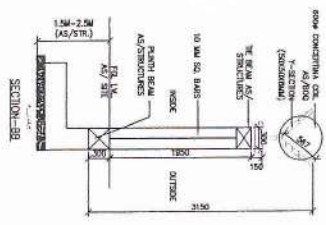
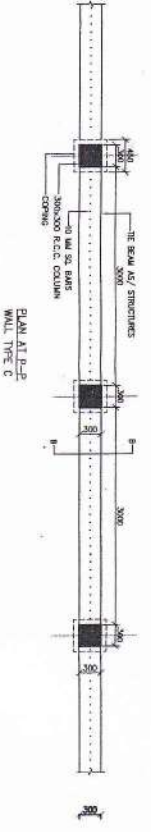
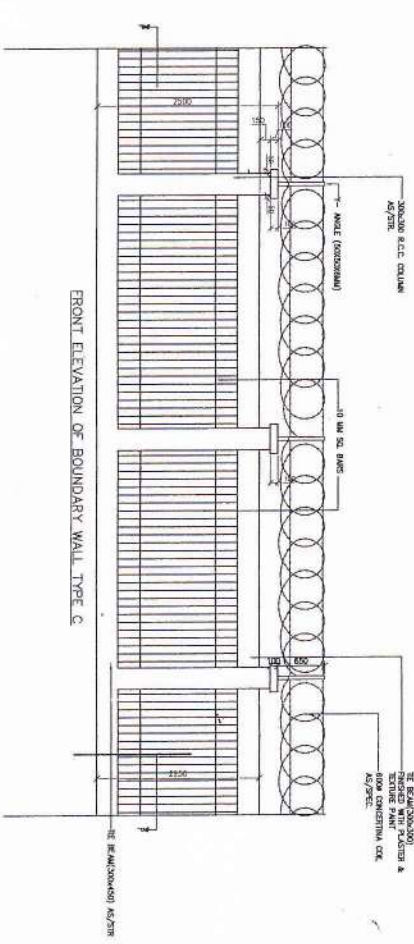

BOUNDARY WALL DETAIL TYPE B

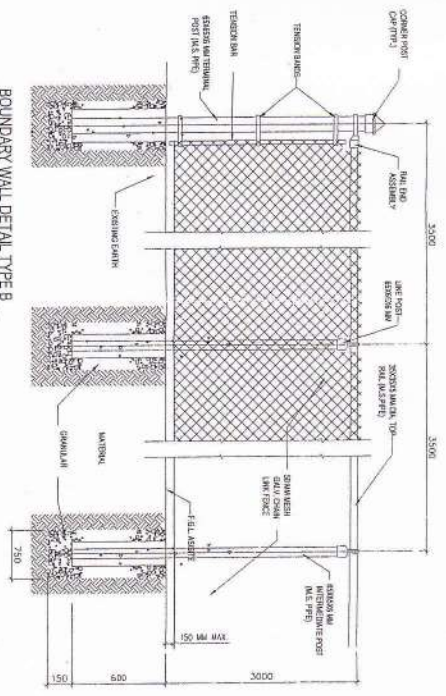

MKD.	DATE	DESCRIPTION	BY
REVISIONS			
NIT UTTARAKHAND			

ISSUED FOR CONSTRUCTION

ISSUED: VEERANDRA  
DATE: 03.01.2014

SCALE: ARCHITECTURE

DATE: JAN. 2014 SITE DEVELOPMENT

DEALT: SEEMA BOUNDARY WALL DETAIL

CHECKED: VEERANDRA TYPE - A & TYPE - B

APPROVED: SAURABH DRG NO. REV.

ENGINEERING AGENCY  
NATIONAL BUILDING CONSTRUCTION CO. LTD.  
CORPORATION LTD. NEW DELHI.

ASSOCIATE CONSULTANT:

ddf CONSULTANTS  
DDF Consultants Pvt. Ltd.